

<b>Code</b>	TO_MOD_DI11IWD	
<b>Dimensions</b>	624 x 373 x 313 mm / 24.6 x 14.7 x 12.3 in <i>Holds approx. 39 litres (10.3 gal)</i>	
<b>Components</b>	<ul style="list-style-type: none"> <li>① Lid</li> <li>② Drip Tray</li> <li>③ Ice Well Vessel</li> <li>④ Valve Assembly</li> <li>⑤ Hose</li> </ul>	<ul style="list-style-type: none"> <li>⑥ Elbow Connector</li> <li>⑦ Ball Valve</li> <li>⑧ Hose Barb Fitting Connector</li> </ul>

**Guidance**

- This product must be assembled by at least 2 people
- Handle with care - please wear protective gloves

### Pre-Use

1. Using the designated hand holds, lower the Ice Well into the trolley's top frame.

**▲ This step must be carried out by at least 2 people ▲**

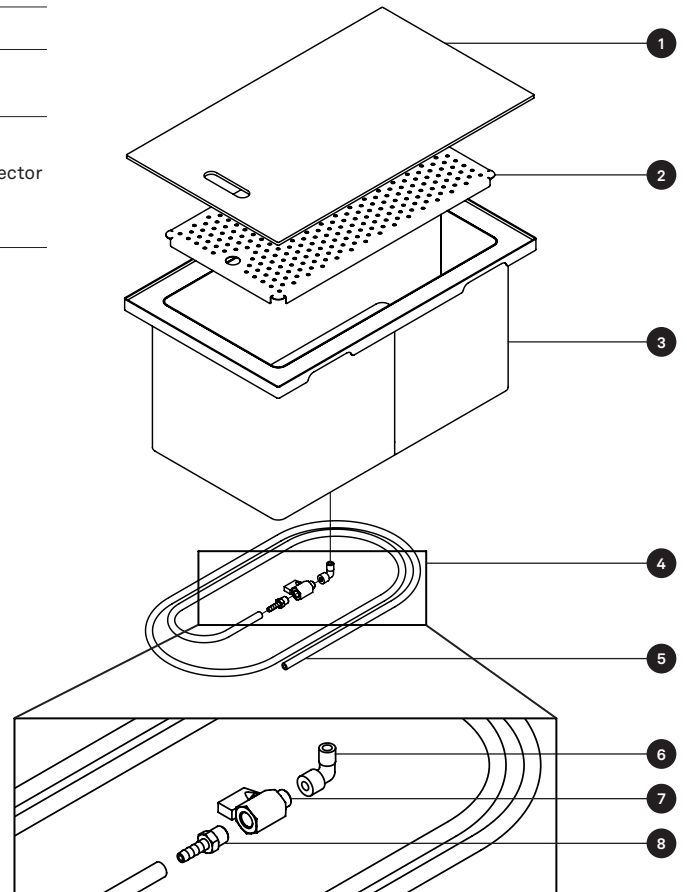
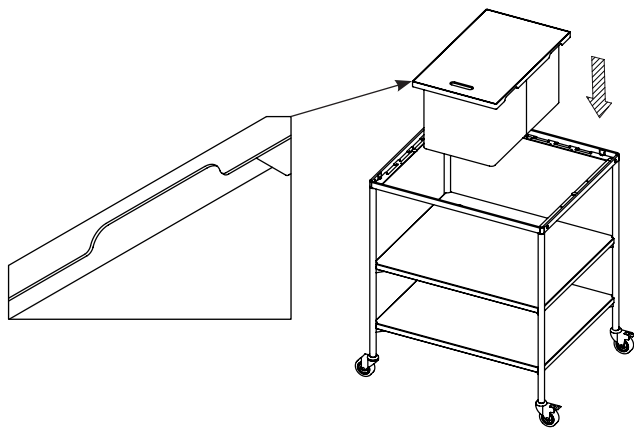

2. Carefully slide the Ice Well to the desired side of the trolley, ensuring it makes contact with the bumpers on the vertical edge of the top frame.

3. Lower the corresponding Filler Panel into the remaining space on the trolley's top frame.

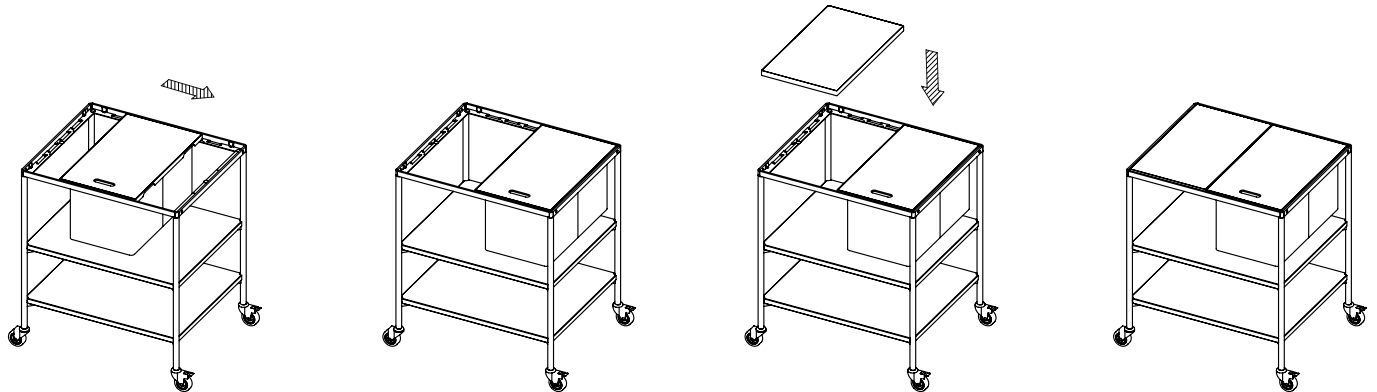

### After Use

1. Remove any remaining ice.

2. To drain liquid:

- Place the end of the hose in a vessel or sink
- Turn the valve lever 90° clockwise

3. Close the valve once draining complete.

**▲ Ensure Ice Well is empty and dry before removing from the trolley frame and storing ▲**

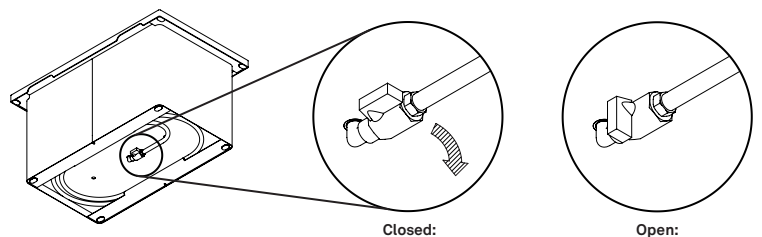

**Company Address**  
Craster Ltd, Suite 216  
Great Western Studios, 65 Alfred Road  
London W2 5EU

**Company Info**  
VAT Reg No. 599599046  
Registered in England  
Company No: 4503732

**UK Telephone**  
+44 (0) 203 004 4750  
**USA Telephone**  
+1 732 543 7862

**Email**  
info@craster.com  
**Web**  
www.craster.com