

craster

USE INSTRUCTIONS FLOW COLD CELL COOLING TRAY

Product Name Flow Cold Cell Cooling Tray

Codes BU_FR0011, BU_FR0012, BU_FF1011, BU_FF0012, BU_FR3011, BU_FR3012, BU_FR4011, BU_FR4012

Components

- ① Flow Cold Cell
- ② Flow Insulating Tray Liner
- ③ Flow Tray
- ④ Flow Low Slate Insert

Caution & Guidance

- Do NOT submerge Cold Cell in water.
- Do NOT place Cold Cell in dishwasher. Wipe clean with damp, non-abrasive cloth with mild detergent.
- Do NOT drop. If damaged, cease use immediately and recycle responsibly.
- ⚠ Risk of frost burn. Handle with care when frozen. Wear insulated gloves.
- For enhanced cooling performance, pair with Flow Tritan Lid Liners

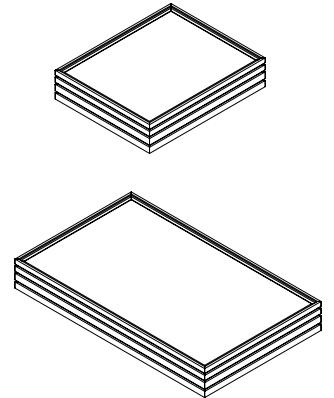

1. Place Cold Cell(s) in freezer at temperature range -18°C (-1°F) to -35°C (-31°F) for a minimum of 4 hours prior to use. For optimum performance freeze for 24 hours.

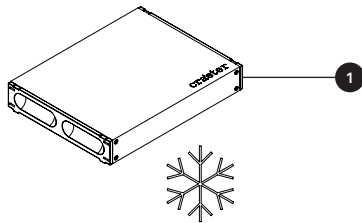

2a. Place the Insulating Tray Liner into the Flow Tray.

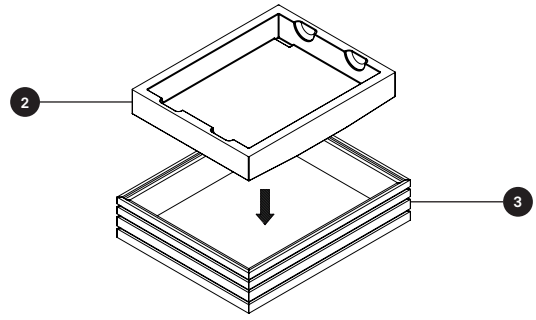

2b. For 1.1 trays, position 2 Insulating Tray Liners as shown:

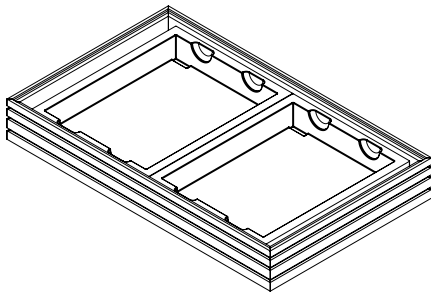

3. Remove Cold Cell(s) from freezer and place inside the Insulating Tray Liner.

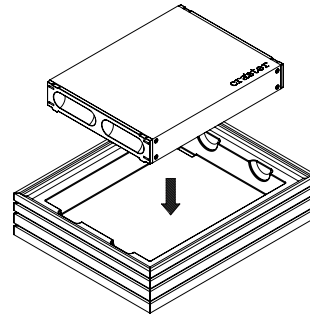

4. Place the Slate Insert on top of the liner.

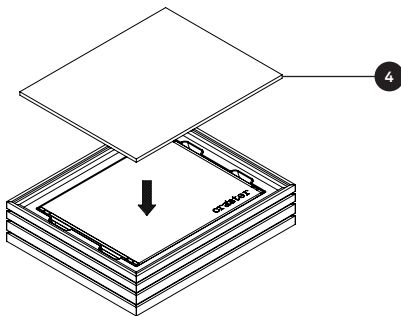

5. Press on the short edge to remove Slate Insert.

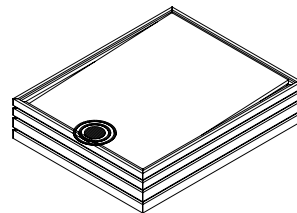

Company Address
Craster Ltd, Suite 216
Great Western Studios, 65 Alfred Road
London W2 5EU

Company Info
VAT Reg No. 599599046
Registered in England
Company No: 4503732

UK Telephone
+44 (0) 203 004 4750
USA Telephone
+1 732 543 7862

Email
info@craster.com
Web
www.craster.com